

Grenze

Grenze

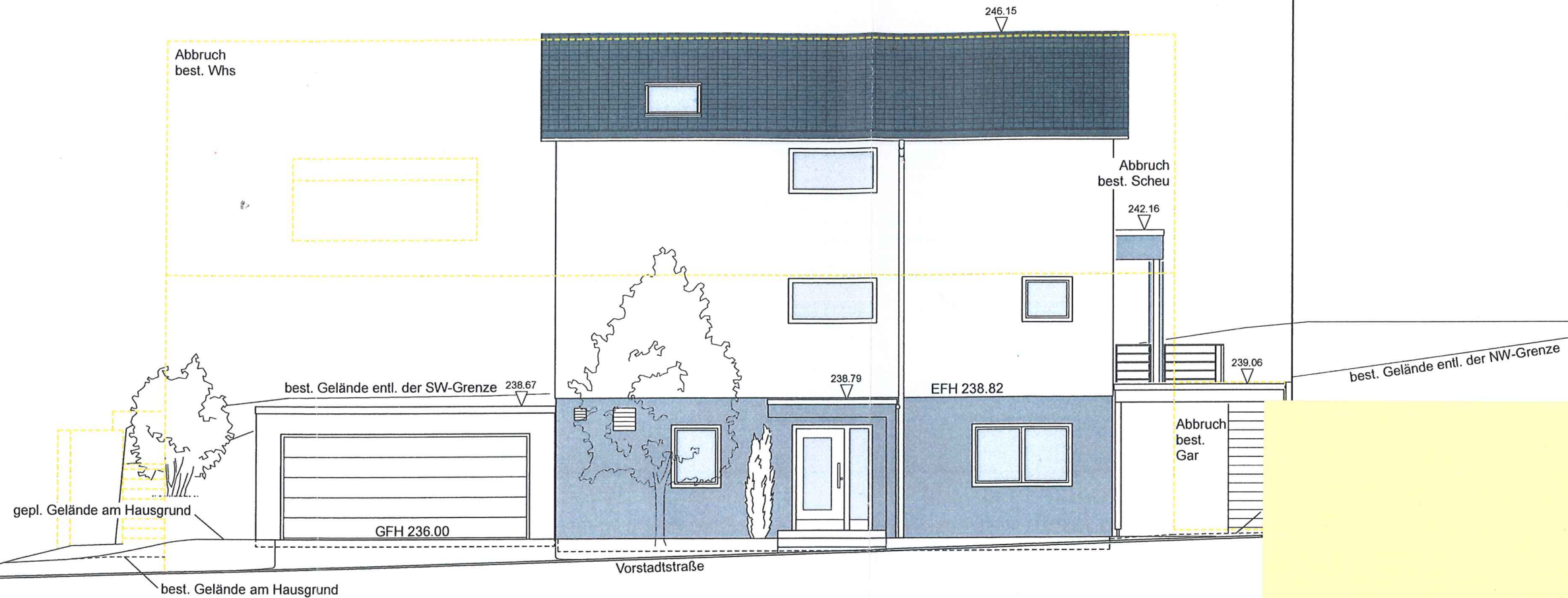

Horizont 234.00m ü. NHN

**PLAN**  
**zentrum**

Dipl.-Ing. A. Muff  
 Hirschmann-Ring 11  
 71726 Benningen  
 0 71 44 / 81 88 44  
 Fax 81 88 45  
 plan-zentrum  
 @t-online.de

PLAN ANSICHT NORDOST	
DAT 21.07.23	M 1 : 100
BAUHERR <i>M. Kauter</i>	
ARCHITEKT <i>[Signature]</i>	

Grenze

Grenze

Vorstadtstraße

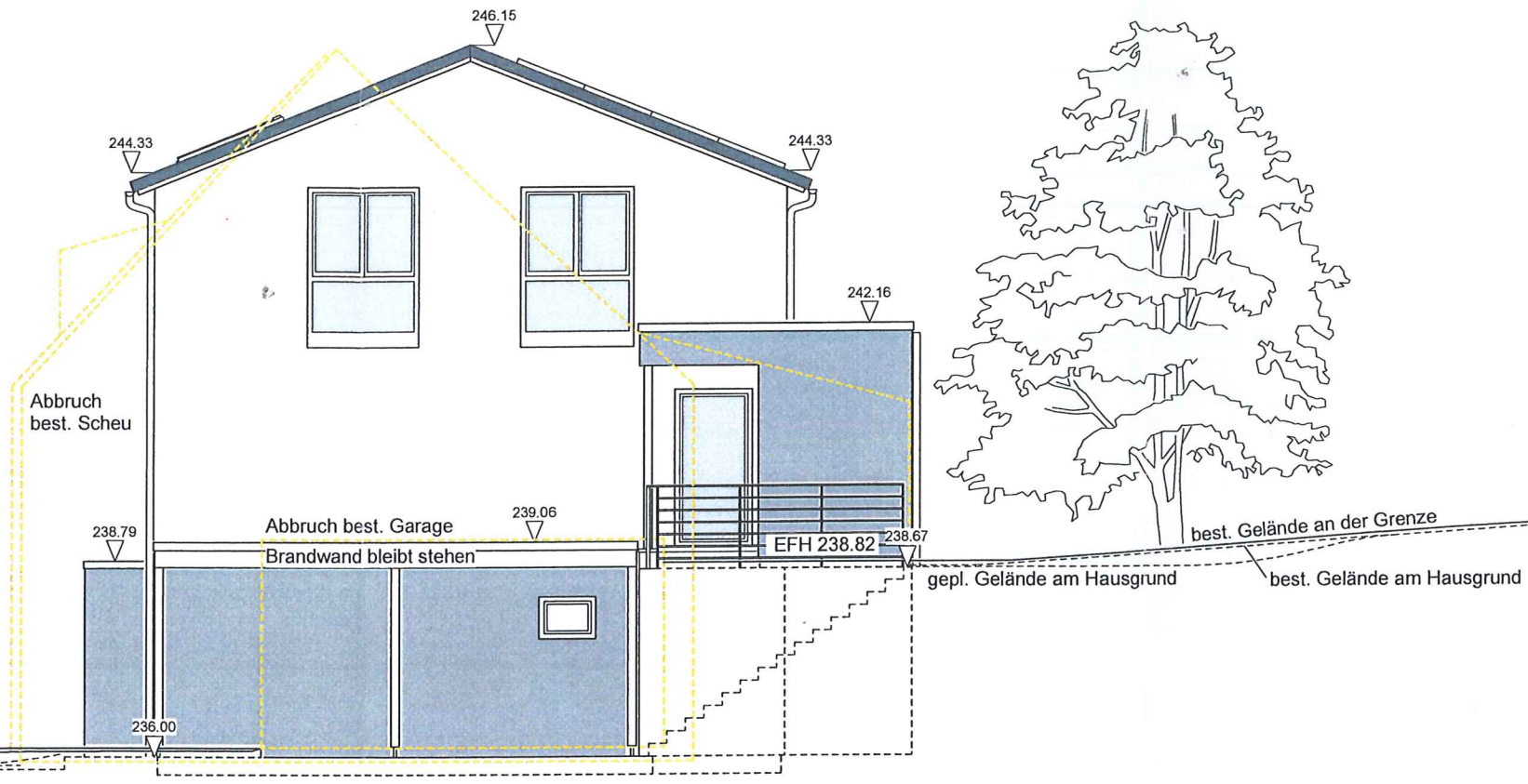

Horizont 234.00m ü. NHN

**PLAN**  
**zentrum**

Dipl.-Ing. A. Muff  
Hirschmann-Ring 11  
71726 Benningen

0 71 44 / 81 88 44  
Fax 81 88 45

plan-zentrum  
@t-online.de

PLAN  
ANSICHT NORDWEST

DAT	21.07.23	M	1 : 100
-----	----------	---	---------

BAUHERR	<i>M. Keubler</i>
---------	-------------------

ARCHITEKT	<i>[Signature]</i>
-----------	--------------------

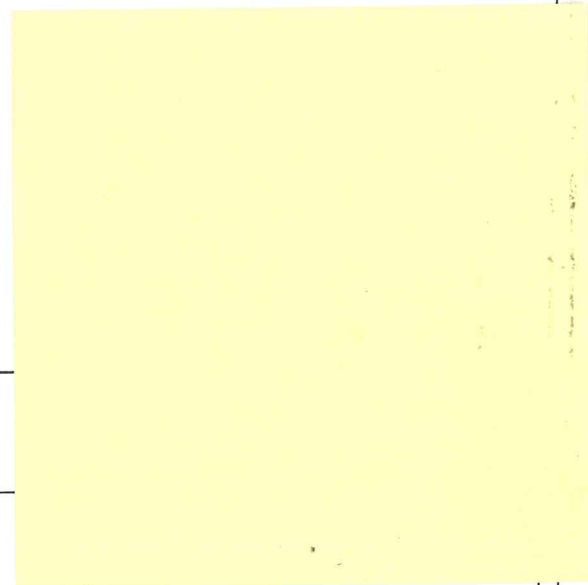

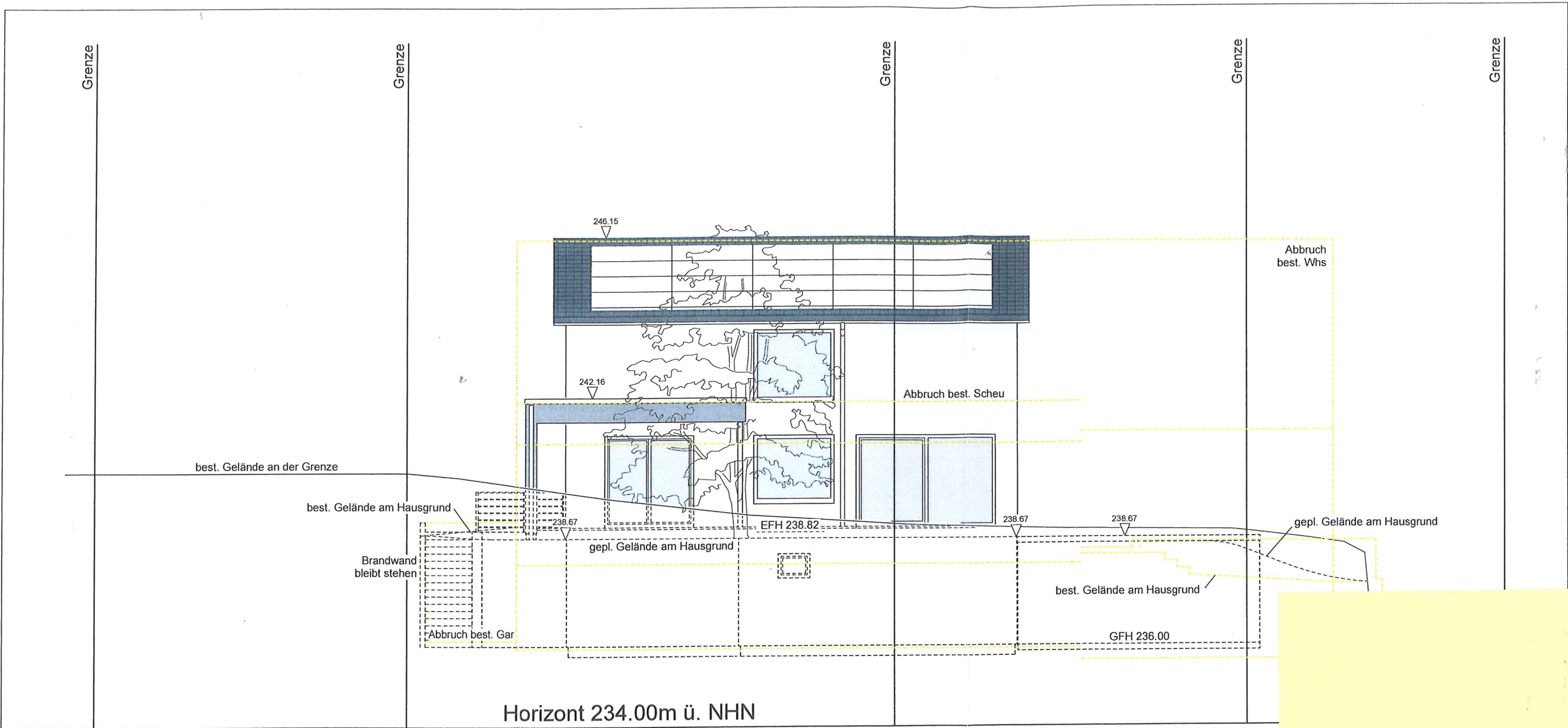

Horizont 234.00m ü. NHN

**PLAN**  
**zentrum**

Dipl.-Ing. A. Muff  
Hirschmann-Ring 11  
71726 Benningen

0 71 44 / 81 88 44  
Fax 81 88 45

plan-zentrum  
@t-online.de

DAT	21.07.23	M	1 : 100
BAUHERR	<i>M. Lauten</i>		
ARCHITEKT	<i>[Signature]</i>		

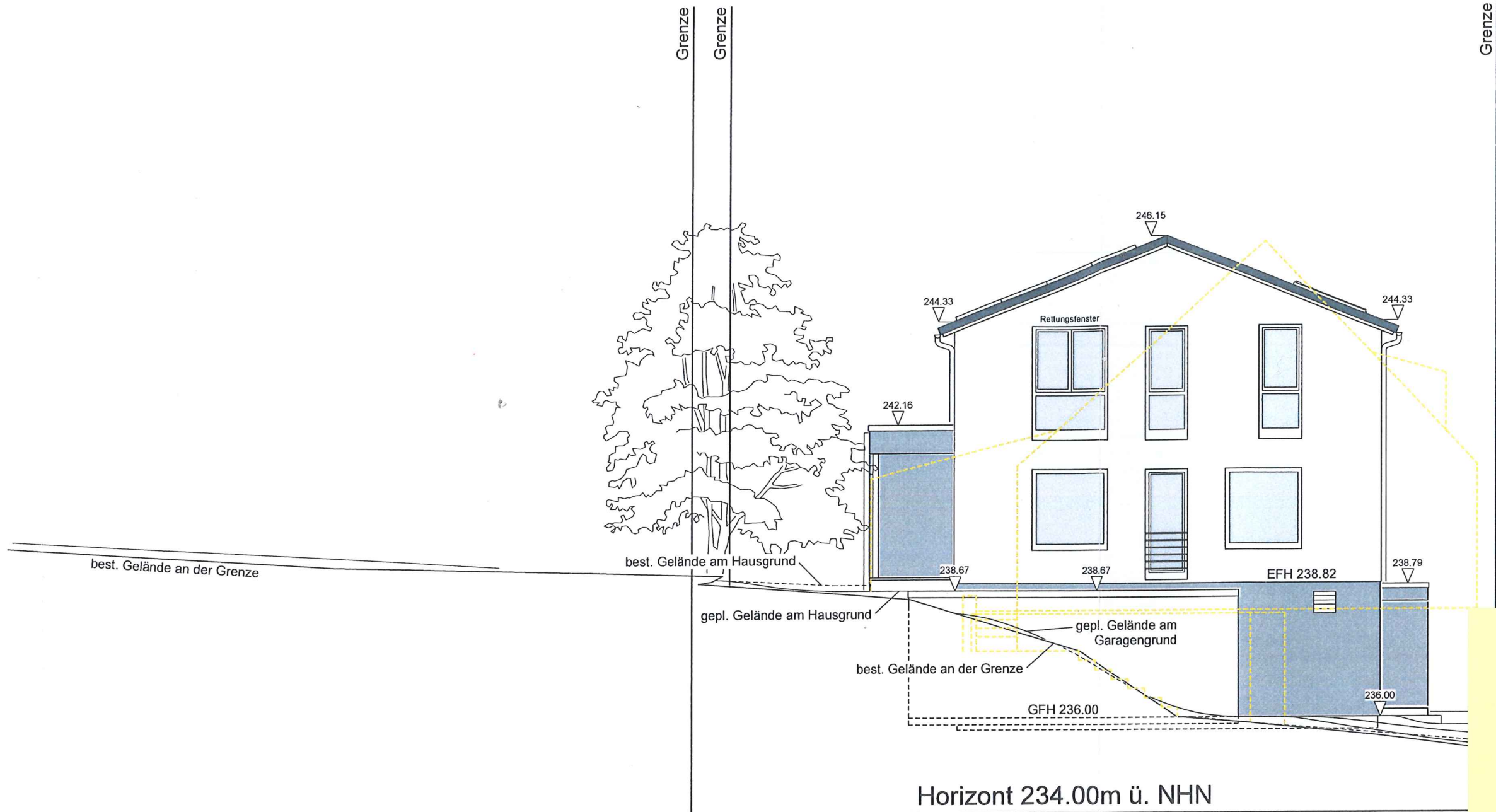

Horizont 234.00m ü. NHN

**PLAN**  
**zentrum**

Dipl.-Ing. A. Muff  
Hirschmann-Ring 11  
71726 Benningen

0 71 44 / 81 88 44  
Fax 81 88 45

plan-zentrum  
@t-online.de

PLAN		ANSICHT SÜDOST	
DAT	21.07.23	M	1 : 100
BAUHERR	<i>M. Laubert</i>		
ARCHITEKT	<i>[Signature]</i>		